

SWING CAST STEEL CHECK VALVE 300LB

Applicable standards:

STEEL CHECK VALVES, API 6D/BS1868
 STEEL CHECK VALVES, ISO 14313
 STEEL VALVES, ASME B16.34
 FACE TO FACE, ASME B16.10
 END FLANGES, ASME B16.5
 BUTTWELDING ENDS, ASME B16.25
 INSPECTION AND TEST, API 598/API 6D

Design description:

BB, BOLTED BONNET CAP
 SWING TYPE, ANTI-ROTATION DISC
 RENEWABLE SEAT RINGS
 NON-PENETRATE DISC SHAFT
 HORIZONTAL OR VERTICAL SERVICE
 FLANGED OR BUTTWELDING ENDS

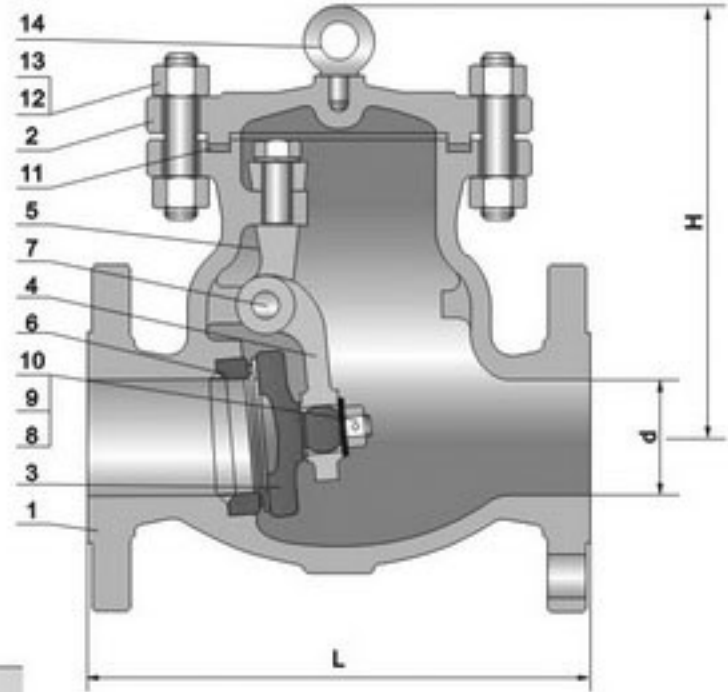

Materials of parts

NO	Part Name	ASTM Material		
		Carbon Steel	1 1/4Cr-1/2Mo	Carbon Steel
1	Body	A216-WCB	A217-WC6	A352-LCB
2	Bonnet Cap	A216-WCB	A217-WC6	A352-LCB
3	Disc ¹⁾	A105-CR13	A182-F11+HF	A350-LF2+CR13
4	Hinge	A216-WCB	A217-WC6	A352-LCB
5	Support	A216-WCB	A217-WC6	A352-LCB
6	Seat Ring	A105+CR13	A182-F11+HF	A350-LF2+CR13
7	Hinge Pin	A276-420	A276-304	A276-420
8	Disc Washer	Carbon Steel	A276-304	Carbon Steel
9	Disc Nut	Carbon Steel	A194-7	Carbon Steel
10	Disc Nut Pin	Carbon Steel	A276-420	Carbon Steel
11	Bonnet Gasket	Spiral Wound (Graphite+304)		
12	Bonnet Stud	A193-B7	A193-B16	A320-L7
13	Bonnet Stud Nut	A194-2H	A194-7	A194-4
14	Eyebolt ²⁾	Carbon Steel		

Note: 1). Cast steel disc for NPS 4" and above.

2). NPS 6" & larger.

3). Disc and seat ring may either be solid facing material or a base material equal to or better than the body/bonnet material with facing as shown.

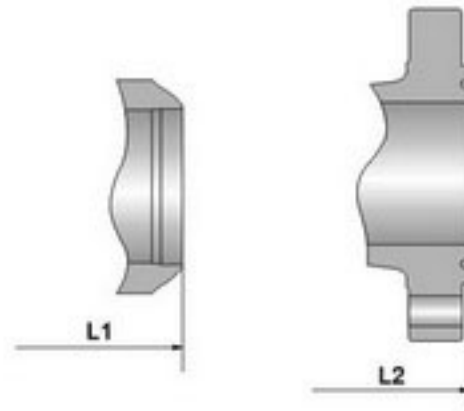

Dimensions data

NPS DN	2 50	2 1/2 65	3 80	4 100	6 150	8 200	10 250	12 300	14 350	16 400	18 450	20 500	24 600	26 650	28 700	30 750	36 900	in mm
ANSI Class 300Lb																		
L/L1 (RF/BW)	10.50 267	11.50 292	12.50 318	14.00 356	17.50 445	21.00 533	24.50 622	28.00 711	33.00 838	34.00 864	38.50 978	40.00 1016	53.00 1346	53.00 1346	59.00 1499	62.75 1594	82.00 2083	in mm
L2 (RTJ)	11.12 283	12.12 308	13.12 333	14.62 371	18.12 460	21.62 549	25.12 638	28.62 727	33.62 854	34.62 879	39.12 994	40.75 1035	53.88 1368	54.00 1372	60.00 1524	63.75 1619	- -	in mm
H	6.00 152	6.50 165	6.88 175	8.00 204	11.50 292	13.88 353	15.38 390	17.00 432	18.75 475	20.62 525	22.88 582	24.62 627	34.75 883	35.88 910	37.00 940	38.62 980	48.00 1220	in mm
(d)	50	63	76	100	150	200	250	300	336	387	431	482	584	635	686	737	876	mm
WT (kg)	16 11	23 13	29 18	46 31	82 61	136 103	204 155	302 245	405 315	625 503	730 593	985 812	1115 895	1465 1205	1840 1525	2290 1895	3180 2395	RF BW